



Digital Information Ltd.



InkZonePerfect - Loop

Pre Installation Check List

Digital Information Ltd.
Technoparkstrasse 1
CH-8005 Zürich

© Copyright by Digital Information Ltd. 2008

The copyright for this technical documentation remains with Digital Information Ltd.

All rights, including reproduction and distribution rights as well as translation rights, are reserved. No part of the documentation may be reproduced in any form (printing, photocopying, microfilm or other process) without written permission, nor may it be stored, processed, reproduced or distributed using electronic systems.

Every misuse is punishable and requires restitution of damages.

Identifier	Pre Installation manual - EN
Target group	Field engineer
Product	InkZoneLoop / InkzonePerfect
Version	V1.2
Article code	InkZoneLoop HB04-024 EN

Table of contents

1	Checklist	1-1
1.1	Recommended hardware for Inkzone computer at press console.....	1-1
1.2	Workflow InkzonePerfect - InkzoneLoop	1-2
1.3	At the press console	1-2
1.4	Colorbar on the sheet	1-2
1.5	Printing specification – Target values LAB or Density	1-3
1.5.1	Target density by PSO	1-3
1.6	Placement of the instrument at 8up or larger press machines	1-3
1.6.1	X-Rite IntelliTrax – ATD - ATS	1-4
1.6.2	Techkon RS400/800.....	1-5
1.6.3	InkzoneMove Track DC8 with EyeOne.....	1-5
1.7	Operator in charge.....	1-6

1 Checklist

1.1 Recommended hardware for Inkzone computer at press console

- CPU Intel Pentium min. 2 GHz
- Memory min. 2 GB
- 19" Touch screen monitor is highly recommended!
- Monitor resolution min. 1024 x 1280
- Hard disk min. 80GB
- 2x Ethernet 10/100 MBit
- min. 4x USB interfaces
- for remote web support, we recommend to have the computer on the internet

Add the interfaces when using:

Product	Add interface
IZWire for MAN consoles	1x Serial RS232 COM port
IZWire for Heidelberg CP2000 Console	2x Serial RS232 COM ports Note: don't use any USB to Serial converter
Techkon RS400 / RS800 scanning system	1x Serial RS232 COM port
X-Rite ATD/ATS scanning system	1x Serial RS232 COM port
IZMoveDCTrack, track system for X-Rite EyeOne	1x Serial RS232 COM port

1.2 Workflow InkzonePerfect - InkzoneLoop

The software InkzonePerfect does the ink preset part of the system. It receives the data from the DI-Plot software and sends it to the InkzoneLoop system.

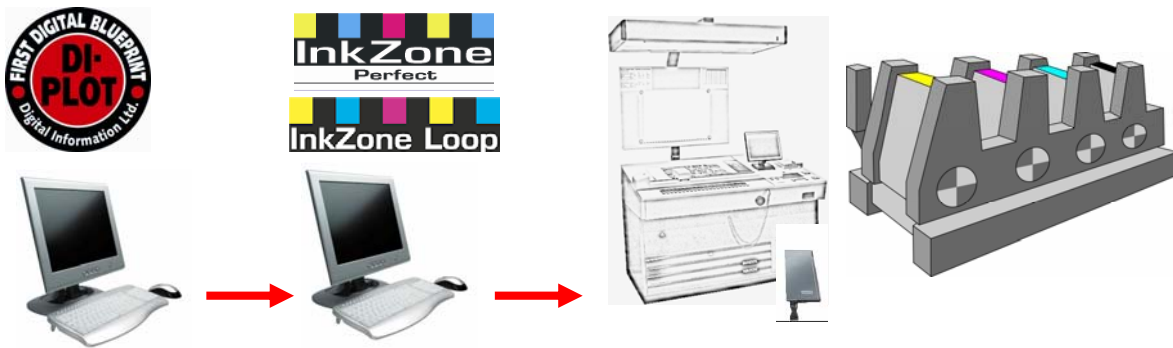

JDF/XML data is
created out of CIP3 or
1-Bit TIFF Bitmap data

Inkzone uses the
JDF/XML data to ink
preset the press

Media emulator is attached to
the console and connected
through Ethernet to the
Inkzone PC

1.3 At the press console

- Ethernet connection to prepress department
- 5 free electrical outlet (1x. PC, 1x monitor, 1x InkCard or InkStrip etc., 1x Densi/Spectro Scanner, 1x Mini Ethernet Switch (used for ITX only), 1x laptop instructor)
- Ethernet cross over cable to connect the PC second Ethernet card to the Inkzone Emulator (IZCard, IZStrip, IZEFloppy).
- Important: the emulators Ethernet connection should not run on the same Ethernet card where the prepress is connected to

1.4 Colorbar on the sheet

- it's mandatory to have exactly one (more is okay but not less) solid patch for each separation/color per ink key
- it's no problem to have any other additional patch (dot gain, slur, grey balance etc) in the control bar
- respect the minimum patch size recommendation from the manufacture

1.5 Printing specification – Target values LAB or Density

Verify if the target densities are known. Is the company printing according the ISO / GRACOL etc specification?

1.5.1 Target density by PSO

Paper type	1	2	3	4	5
Cyan	1.55	1.45	1.45	1.00	1.0
Magenta	1.50	1.40	1.35	0.95	0.95
Yellow	1.45	1.25	1.25	0.95	0.90
Black	1.85	1.75	1.75	1.25	1.20

Paper type 1 Offset printing: glossy coated over 70 g/m2 (ISO 12647-2)

Paper type 2 Offset printing: matt coated over 70 g/m2 (ISO 12647-2)

Paper type 3: Glossy coated web offset paper, 60 to 70 g/m2 (ISO 12647-2)

Paper type 4: Uncoated white paper (ISO 12647-2)

Paper type 5: Uncoated slightly yellowish

1.6 Placement of the instrument at 8up or larger press machines

Most console are designed to place the printed sheet with the maximum paper size on there desks, like Heidelberg or Komori etc. The desks are about 80 cm depth.

By placing additionally a scan system on the desk, the 80 cm depth is reduced by the instrument size, resulting that there is not enough space to store the scanned sheet.

There are two solutions:

- 1) Use a second desk for the measuring device
- 2) Pick an idea from below.

1.6.1 X-Rite IntelliTrax – ATD - ATS

Under the left and right side corner a little block has been placed to lift the device up, helping to place the sheet after the scan has been done underneath it.

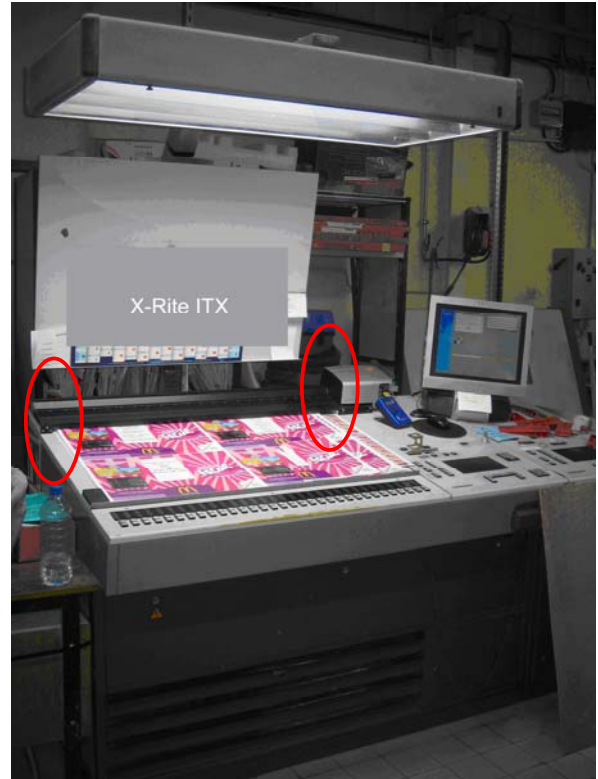

1.6.2 Techkon RS400/800

When using a Techkon device, place a metal plate (1,5mm thickness) on the console desk with the size of 104 x 90 cm.

The track bar with the magnets on each side can now be placed very easily on any position on the desk to scan any positioned colorbar.



1.6.3 InkzoneMove Track DC8 with EyeOne

The console has been moved away from the wall to gain a gap of about 15cm.

At the wall two brackets are holding the instrument.

After the scan, the sheet can be placed at the “front” of the console.



A console desk which is curved inwards will result in faulty measurement!

When using the IZM Track system, the console desk has to be absolutely flat. Please check the “DCx Setup.pdf” document.

1.7 Operator in charge

Organize a training session for one employee to qualify him as a “super admin user”. This training session provides additional information on the configuration and the setup of the system.